



# AFINION™ CRP QUICK REFERENCE GUIDE



## Preparing for analysis

### AFINION™ CRP Test Cartridge

- Store the test kit refrigerated (2-8°C) until the expiry date or at room temperature (15-25°C) for maximum 4 weeks.
- The test cartridge must reach a temperature of 15-30°C before use; leave the unopened foil pouch on the bench for at least 15 minutes.
- Use the test cartridge within 10 minutes after opening the foil pouch.
- Hold the test cartridge by the handle.

### Patient Sample

- Use capillary blood directly from finger, venous whole blood (with EDTA or heparin), serum or plasma.
- Venous whole blood should be analysed within 3 days. Serum or plasma can be stored refrigerated (2-8°C) for 10 days. Capillary samples cannot be stored.
- Mix the sample by inverting the tube 8-10 times before use.

### AFINION™ CRP Control

- Store the controls refrigerated (2-8°C). Opened controls are stable for 4 weeks.
- The control can be used directly from the refrigerator.
- Mix the control by inverting the vial 8-10 times before use.
- The measured value should be within the acceptable range stated in the Afinion™ CRP Control Package Insert.

### AFINION™ 2 Analyzer

- Switch on the analyzer and optionally enter the operator ID.
- Analyse patient samples and controls following the test procedure on the reverse side.
- An information code might be displayed during analysis. The possible causes and actions to take are listed in the **AFINION™ 2 Analyzer User Manual**.



Information codes specific for the AFINION™ CRP assay:

Code	Cause
101	Hematocrit below 20%
102	Hematocrit above 60%



**Consult the AFINION™ User Instructions for complete information:**

- Afinion CRP Package Insert.
- Afinion CRP Control Package Insert.
- **AFINION 2 Analyzer User Manual**.

## Testing Procedure

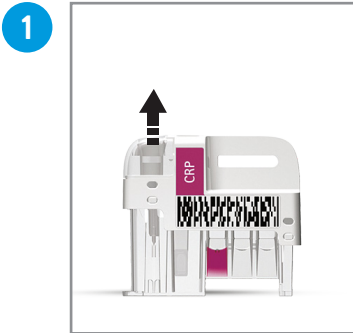

1 Pull the sampling device straight up from the test cartridge.

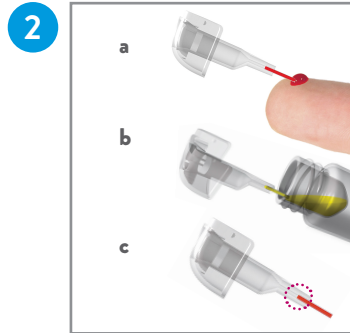

2 Fill the capillary completely (c) with patient sample (a) or control (b). Do not wipe off the capillary.

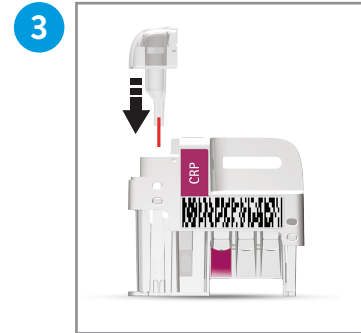

3 Replace the sampling device immediately. Analysis of the test cartridge must start within 1 minute.



4 Touch for patient samples, or touch for controls. The lid opens automatically.



5 Insert the test cartridge with the barcode facing left.



6 Close the lid manually to start analysing.



7 Touch and enter patient ID, or touch and enter control ID. Touch to confirm.



8 Record the result when it appears on the screen. Touch to accept. The lid opens automatically.



9 Remove and immediately discard the used test cartridge. Close the lid manually when the analyzer is not in use.